



Technical informations

Length	14.95 mètres
Width	3.85 mètres
Recommended capacity	8
Number of cabins	4
Bathroom / Toilette	1
Size Livingroom	7 m ²
Kitchen equipment	130 L fridge (freezer compartment), Twin-hob stove/oven
Drinking Water Reservoir	1050 L
Propulsion energy	diesel
Fuel tank	375 L
Double steering	Yes
Air conditioner	Yes
Bow thruster	Yes
Other equipment	220-volt shore power supply, Radio CD/MP3, Terrace with garden furniture on request

Octo Fly C

495,000€



The Octo Fly C is a river cruiser that ideally accommodates four couples or three couples with two children.

The Nicols Octo Fly C from the Fly range is 15 metres long and is the largest model (or “flagship boat”) produced in the Nicols boatyards. Thanks to its bow propeller, piloting the Octo Fly C is child’s play.

This river cruiser comes with four cabins and four bathrooms and offers the highest level of comfort you can find on the river tourism market with a large fridge, hob and oven, satellite television, radio/CD/MP3 player, 220-Volt shore power supply, a generator to benefit from those 220 Volts even when out on the water and air conditioning which is a welcome addition on the Canal du Midi!

The boat has a covered aft terrace with garden furniture and access to the upper deck where you will find a dining area with an outdoor kitchen (sink, plancha grill) under the shade of a bimini top, a second outdoor cockpit and two deck cushions for lounging outside.

As with the other boats in the Estivale range, swimmers will be delighted to find a boarding ladder and a deck shower.

Don’t wait any longer to cast off on this licence-free houseboat with extraordinary features!

[>>View the PDF brochure](#)

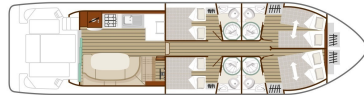
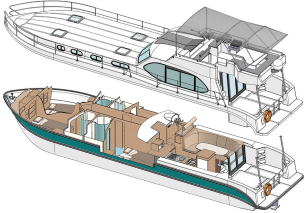

Technical Description

MATERIALS

- White-coloured polyester for deck and flying bridge
- White-coloured polyester and sea-green stripe for hull

INTERIOR MATERIALS

- Partition walls: water-repellent melamine chipboard, "light oak" colour, 16 mm
- Counter-moulded ceiling in polyester, ivory RAL 1013 colour
- Single-unit shower room, polyester, ivory RAL 1013 colour
- PVC floor covering in "medium walnut" colour
- Hull bottom frames and structures: joinery deal and CTBX plywood, 19 and 40 mm
- Mattress and seat top in 15 cm thick Bultex foam, covered in leatherette

FITTINGS



- Handrail in stainless steel tubing, diameter 20
- 1 fore railing in 2 sections with intermediary tubing and fore passage (stainless steel, diameter 23)
- 1 aft guardrail with 2 opening gates (stainless steel tubing, diameter 23)
- 4 reinforced chandeliers
- 10 single chandeliers
- 2 rows of railings (sheathed stainless steel) to starboard and port side
- 6 x 250 cleats (anodised alu)
- 4 navigation lights
- 3 black PVC sheer rails attached to the hull, incl. 1 at level of hull/deck connection
- 2 gangway supports in opening of side gates
- 1 aluminium gangway
- 1 roller support for anchor chain
- 1 electric windscreen wiper
- 1 audio warning device
- Fly equipped with handrails

MOTORISATION

- 1 x 50 CV in-board diesel motor (shaftline) equipped with a hydraulic shutter with flexible coupling
- 1 x 2-station hydraulic steering system
- *Main cockpit (saloon)*: 1 mono-lever gas compartment, 1 tachometer, 1 fuel indicator, 1 hour meter, 1 rudder angle indicator, 1 engine oil temperature indicator, 1 battery-level indicator and 1 waste water tank level indicator.
- *Secondary cockpit (flying bridge)*: 1 mono-lever gas compartment, 1 tachometer, 1 rudder angle indicator.
- 1 engine hold with sound-insulating foam

BOW THRUSTER

- 80 kg fore thruster
- 80 kg aft thruster
- Single control for both thrusters

GENERATOR

- 6 kW

WASTE WATER STORAGE

- 2 stainless steel double tanks with a total capacity of 400 litres
- 1 deck drain for emptying tanks

INTERIOR EQUIPMENT

Saloon

- 1 two-seat "pilot" bench
- 1 windscreen demisting fan heater
- 1 "C"-shaped bench, convertible into a double bed
- 1 beige coloured polyester table
- 1 electric refrigerator / freezer, 220 L, 220 volts
- 1 single-bowl sink (100 x 60) with draining board and mixer tap



- 1 x 4-hob hotplate with piezzo electric ignition
- 1 kitchen unit in 16-mm thick "light oak" coloured water-repellent chipboard
- 1 oven (gas-powered)
- 1 automatic bin door
- 1 x 22" LCD colour TV with DVD player – Satellite reception
- 1 microwave (220 V power supply)
- 1 Bluetooth FUSION radio – USB player – 2 speakers
- Dishwasher, 10 place settings
- 220 V socket
- USB port

2 fore cabins

- 1 140×190 double bed convertible into 2 single beds with 15 cm thick foam mattress
- Storage compartment under bed
- Wardrobe
- Storage units
- 2 opening portholes
- 2 square opening deck hatches
- Direct access to shower room and WC
- Mosquito screen/roll-up blind combination
- LED bedside lamps
- 220 V socket
- USB port

2 aft cabins

- 1 x 140×190 double bed with 15 cm thick foam mattress
- Storage compartment under bed
- Storage units
- 2 opening portholes
- 2 square opening deck hatches
- Direct access to shower room and WC
- Mosquito screen/roll-up blind combination
- LED bedside lamps
- 220 V socket
- USB port

4 shower cubicles – WCs

- 1 full round shower with access via 2 sliding doors in green-tinted Plexiglas and thermostatic tap
- 1 ceramic electric WC
- 1 beige polyester washbowl with mixer tap
- 1 storage unit
- 2 coat hooks
- 1 sliding porthole with opaque film on window and mosquito screen
- 1 solar ventilator
- LED spotlighting

EXTERIOR EQUIPMENT

- 1 sliding sun awning
- 1 deck shower head accessible from aft platform



- Under-fly lighting with LED spotlights
- 1 swimming ladder
- 2 hook housings
- 1 fixed stairway for flying bridge access
- 2 spotlights integrated in the hull

FLY EQUIPMENT

- Large bench seat moulded into the fly
- Sun lounger with folding backrest
- Pilot bench and co-pilot bench
- LED ambient lighting
- Gas plancha grill
- Sink
- White polyester panel convertible into a large sunbathing deck
- Glass/can holder
- Remote control for the radio
- Waterproof speakers

WINDOWS – OPENINGS

- 1 curved safety glass windscreen, 5 mm, in 5 parts, incl. 2 opening
- Saloon sliding bay windows in 4 mm green-tinted safety glass and surrounding profile in lacquered aluminium
- Aft sliding bay window, 2 casements in grey lacquered aluminium
- Fixed and opening portholes in green-tinted glass, grey lacquered aluminium frame, 4 square opening deck hatches, green-tinted

SERVICES

Energy

- 2 x 220-volt shore power supply sockets
- 1 x 50 AH battery (generator start-up)
- 1 x 100 AH battery (engine starting)
- 2 x 100 AH slow discharge batteries (electric fore thruster)
- 2 x 100 AH slow discharge batteries (electric aft thruster)
- 2 x 100 AH slow discharge batteries (services)
- 3 x 100 AH slow discharge batteries (refrigerator)
- 2 x 2-way charge separator
- 2 x 25 AH battery charger
- Generator to power dishwasher, air conditioners and saloon outlet socket

Drainage

- 1 switch + 1 engine hold pump
- 1 switch + 1 fore shower pump
- 1 switch + 1 keel pump
- 1 switch + 1 propeller compartment pump

Water



- 1,050 litre water tank, incl. 80 litre hot water tank
- Pressurised hot water and cold water with accumulator tank
- Hot water production with lagged 80-litre heat exchanger tank
- 2,000 W water heater element on shore power supply

Gas

- 2 self-emptying gas compartments for 13 kg cylinders

Heating

- 2 WEBASTO AIR TOP 55 forced-air heating systems

Air conditioning

- 2 WEBASTO BLUE COOL S16 air conditioning units powered either by the generator or shore power supply.

Lighting

- Lighting via recessed LED spotlights, directional LED spotlights and LED wall lights.
- Two-way switch lighting in the fore cabins, corridor and saloon



Our contact informations

Are you interested in this model and would you like more information? **Do not hesitate to contact us.** Nicols Route du Puy Saint Bonnet 49300 Cholet - France **02 41 56 46 56**

